

Manual



for the professional craftsman

All you need to know about the quick and reliable application of SIGA high-performance products.

SIGA⁺

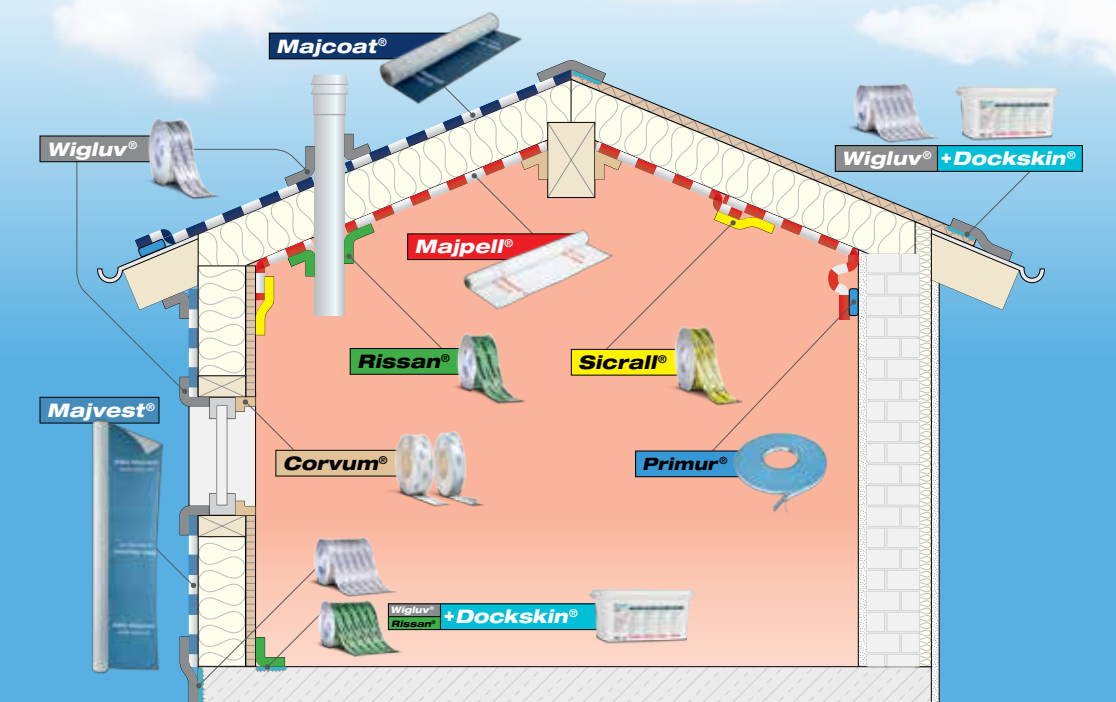

SIGA⁺ house-tight air and windtightness system

- ✓ permanently reduce your energy consumption
- ✓ no drafts
- ✓ long-term building value

The best reliability and expertise

SIGA is an owner-managed, second-generation family business.

Find out more at: www.sigacover.com



SIGA Research applies for new patents every year

- ▶ Benefit from our latest research and development! The competent SIGA Research Team comprising of chemists, engineers, application engineers and construction physicists works in two laboratories to research and develop new products just for you.



SIGA Factory 1 & Laboratory, Schachen, Switzerland



SIGA Factory 2, Academy & Laboratory, Ruswil, Switzerland



Support environmentally-friendly production!

- ▶ SIGA produces with natural gas, multi-stage heat recovery and rain water. The clean waste is used for producing heating energy. The waste water is cleaned. The new buildings are made out of wood.



SIGA trains professional craftsmen in the SIGA Academy

- ▶ Find out in the SIGA laboratory and SIGA production plant why SIGA products offer you the best reliability in the long term.

SIGA trains professional craftsmen in workshops

- ▶ Learn how to save time and money when working with SIGA products while still achieving the best reliability.

Professional quality for professional craftsmen

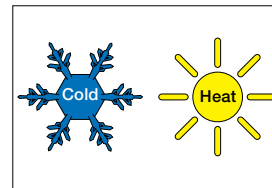

✓ SIGA immediately forms an extremely strong bond:

- On difficult substrates
- In hot and cold temperatures

Professional craftsmen save a lot of time and bother



✓ SIGA has not had a situation where its correctly applied products lead to a building damage:

- Durably strong adhesiveness
- Resistant to ageing

Professional craftsmen reliably protect both themselves and the building owner by preventing building damage with correctly applied products.



✓ SIGA products are free of domestic toxins as:

- Solvents
- VOC
- High-boiling substances
- Plasticisers
- Chlorine
- Formaldehyde

This helps professional craftsmen meet the demands from surveyors and building owners to counter excessively high toxin values in indoor air

⚠ WARNING

Follow all warnings, cautions and instructions when using power tools and observe appropriate safety precautions when working on roofs or any slanted surface.

Installation Safety Information:

SIGA products are intended for installation by professional craftsman only and should not be installed by a homeowner and/or consumer. Professional installation is required to achieve the intended results and to minimize risk of damage to person and/or property.

⚠ CAUTION

Exercise due care when working with cutting tools and use gloves if your hands may encounter sharp surfaces.



Construction feature and SIGA solution 8 – 10

Vapor control layer or wood-based panel materials 11 – 43

11 – 12

Majpell® 5 **Twinet®**

- 12 • Mounting on metal substructures
- 13 • Mounting on wooden substructures

14

Sicrall® 60

- 15 • Overlap

16

Rissan® 60

- 17 • Circular penetration
- 17 • Butt-joint

18

Primur® Roll

- 19 • Stucco

22

Primur® tubular bag and cartridge

- 23 • Stucco

24

Corvum® 30/30

- 25 • Angular penetration
- 26 • Purlin
- 27 • Inside corner
- 28 – 29 • Outside corner
- 30 – 32 • Skylight

33

Corvum® 12/48

34 – 35

- Recessed window and door frame

36

- Protruding window and door frame

37 – 40

Majpell® 5 **Twinet®** **Sicrall® 170**

- Vapor control layer for blown-in insulation

41

Sicrall® 170

41

- Wood-based panels for blown-in insulation

42

Rissan® 100 & 150 **Dockskin®**

43

- Base-joint



Construction feature and SIGA solution 44 – 48

Roof underlay membrane 49 – 60

49 **Majcoat®**
50 – 52 • Mounting

53 **Wigluv® 60**
54 • Overlap
55 • Penetration
56 – 57 • Skylight

58 – 59 **Primur® Roll** **Wigluv® 100** **Dockskin®**
58 – 59 • Stucco

60 **Nail sealing tape II**
60 • Mounting

Facade membrane 63 – 69

63 **Majvest®**
64 • Mounting

65 **Wigluv® 60**
65 • Overlap
66 • Penetration
67 • Window

68 **Wigluv® 100 & 150** **Dockskin®** **Primur® Roll** **Wigluv® 60**
69 • Base-joint

Visible facade membranes 70 – 71

70 **Wigluv® black**
70 • Overlap
71 • Penetration
71 • Window

Soft woodfiber insulation boards 72 – 77

72 – 73 **Wigluv® 100 & 150** **Dockskin®**
74 • Joint
74 • Covering membrane
75 • Penetration
76 • Skylight
77 • Base-joint

SIGA services 78 – 81

78 • SIGA products at your local dealer
79 • Valuable information
80 • Enlighten your customers
81 • Protect your work!

SIGA reliability 82 – 85

82 – 83 • Warranty and technical details
84 – 85 • Suitable substrates and membranes
86 – 89 • General Terms and Conditions

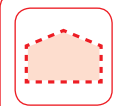

Vapor control layer or wood-based panel materials

Mounting

Majpell® 5
Twinet®

11 – 13

Overlap

Sicrall® 60

14 – 15

Circular penetration
and butt-joint**Rissan® 60**

16 – 17

Stucco

Primur®

18 – 23

Angular penetration

Corvum® 30/30

24 – 25

Purlin

Corvum® 30/30

26

Inside and outside corner

Corvum® 30/30

27 – 29

Skylight

Corvum® 30/30

30 – 32

Window and door frame

Corvum® 12/48

33 – 36

Vapor control layer
for blown-in insulation**Majpell® 5**
Twinet®
Sicrall® 170

37 – 40

Wood-based panels
for blown-in insulation**Sicrall® 170**

41

Base-joint

Rissan® 100 & 150
Dockskin®

42 – 43



SIGA-house-tight

Making the building shell **airtight**

Use the following SIGA products for the reliable sealing of your airtight building shell:

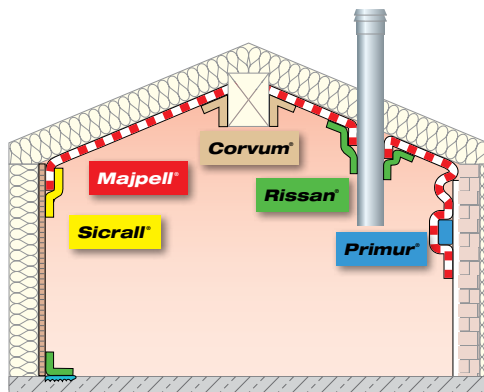

This is why all critical areas must be carefully sealed to be airtight, e.g.:

- At wood based panel joints
- At overlaps in the vapor control layer
- Circular and angular penetrations
- Base-joints
- Leaks in the vapor control layer
- The area where the vapor control layer is joined to the stucco

It is important to look out for first-class quality when selecting the product to be used! Lower quality products often contain solvents and resins and can thus lose their adhesiveness after a short time and cause emissions in the living area.

- Buildings must be constructed to be **permanently airtight**.
- To make the building shell airtight, vapor control layers are applied and bonded airtightly to the inside of the building shell.
- Subsequently proof of airtightness is provided with the Blower-Door-Test by checking the airtight layer for compliance with the required values.
- Permeable areas in the building shell cause high energy loss, uncomfortable drafts and can lead to massive damage to the building.



SIGA high-performance adhesives are free of domestic toxins and environmentally friendly. They have an extremely strong bond, even after decades. They are easy to apply and ensure a durable airtight building shell when installed correctly.

Find out more about airtightness and the blower door test at:
www.sigacover.com

Vapor control layer or wood-based panel materials

SIGA

Majpell® 5 the vapor control layer for roof, wall and ceiling structures

4.9 ft and 9.8 ft

3 m x 50 m = 150 m² / 22 kg
9.8 ft x 164 ft = 1614 ft² / 48.50 lb
Item no. 8510-300050

1.5 m x 50 m = 75 m² / 11 kg
4.9 ft x 164 ft = 807 ft² / 24.25 lb
Item no. 8510-150050

- ✓ for between-rafter insulation
1 vapor control layer only for all common constructions
- ✓ sturdy, flexible and dimensionally stable
can be laid quickly, easily and without wrinkles
- ✓ vapor permeable, fixed US perms 0.68
intelligent moisture management

Tips and Tricks

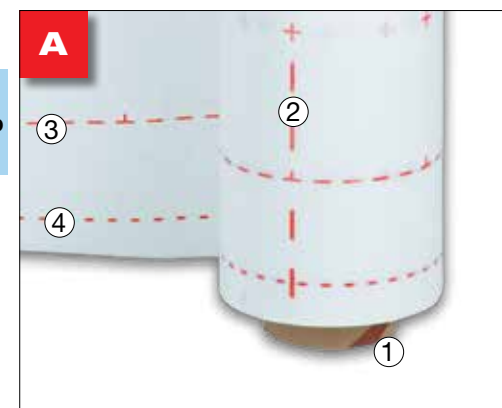

- **Protruding roll core ①** protects Majpell right up to the last meter/inch
- **The cutting aid, ② laying aid ③ and bonding aid ④** save time

PO layer, reinforced with PP fibres,
thickness 0.4 mm / 0.016"
Weight per unit area: 126 g/m² / 0.43 oz/ft²
CE, EN 13984, type A

UV-stable up to 3 months
Fire behaviour: class E (according to EN 13501-1)
s_d value: 5 m
0.68 US perms

SIGA Stick with us.®

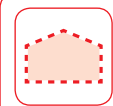

SIGA-house-tight

Vapor control layer or wood-based panel materials

Twinet® double-sided adhesive tape for the pre-installation of vapor control layers on hard substrates



Item no. 6610-2050, Box: 10 rolls,
roll: width x length: 20 mm x 50 m / 0.79" x 164 ft
Non-woven carrier, 0.35 mm / 0.014" thick

- ✓ extremely adhesive on both sides
quick, safe installation
without staples
- ✓ protective coating prevents soiling
simple to apply up to the end
- ✓ tearproof backing strip
saves time

Twinet is not suitable for permanent load-bearing applications. After installation, the vapor control layer must be additionally fastened, e.g. using jack rafters, counter battens, facing.

Mounting on metal substructures



Use double-sided adhesive Twinet when mounting Majpell on metal substructures

- Saves time



- Unroll Majpell, cut it to the correct size
- Stick it down with the smooth side and the writing facing you
- Overlap the sheets by approx. 4"

Mounting on wooden substructures



Use double-sided adhesive Twinet when mounting Majpell onto wooden substructures

- Avoids leaky stapling points



- Unroll Majpell and cut it to size



- Bond Majpell with the smooth side and the writing facing you
- Overlap the sheets by approx. 4"



After adhesion:

- Screw battens crosswise or lengthwise along the structure (to bear the weight of the insulation material)
- Mount the interior cladding (protects against mechanical influences and UV)

Airtightness

SIGA



SIGA-house-tight

Vapor control layer

Sicrall® 60 single-sided high-performance adhesive tape for overlaps



Item no. 4510-6040, Box: 10 rolls,
roll: width x length: 60 mm x 40 m / 2.4" x 131 ft
Special reinforced paper: splash-water repellent,
hand-tearable

- ✓ extremely strong adhesion
reliable
- ✓ sturdy carrier material
saves time in case of
long overlaps
- ✓ hand-tearable
saves time

Tips and Tricks



In case of cellulose insulation

- Before injecting the insulation, we recommend laying the sheeting in rafter direction, bonding underneath the rafters and screw battens on to the structure (see page 37)



Sealing the crease so that it is airtight:

- Seal the crease in a "T" shape away from the overlap using Sicrall

Airtightness

SIGA®

Overlap

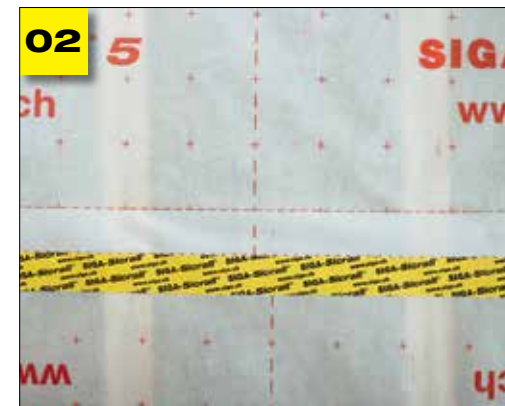

- Release the Sicrall backing strip
- Position Sicrall in the center of the overlap and secure it in place
- Remove the backing strip
- Apply Sicrall free of tension and creases and press it down vigorously

How it should look:

- The overlap is sealed with Sicrall and permanently airtight

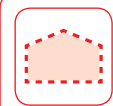

SIGA-house-tight

Vapor control layer or wood-based panel materials

Rissan® 60 single-sided high performance tape for circular penetration and for overlaps on wood-based panel material



Item no. 2510-6025, Box: 10 rolls,
roll: width x length: 60 mm x 25 m / 2.4" x 82 ft
Special, reinforced PE film, elastic

- ✓ extremely strong adhesion
reliable
- ✓ smooth carrier material
clings tightly around pipes
and cables
- ✓ elastic
remains sealed despite structural
movements

Tips and Tricks



- For short pieces, separate Rissan from its backing strip
- Pull on Rissan and the **backing strip** simultaneously



- Block Rissan roll with one hand
- Use other hand to tear off Rissan over blade with a quick jerking movement

Airtightness

SIGA®

Circular penetration

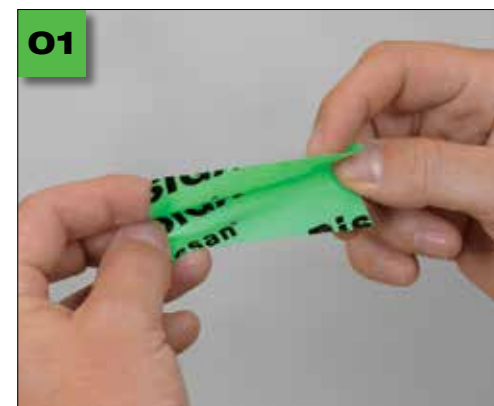

- Crease Rissan lengthwise



- Apply Rissan half to the pipe and half to the the vapor control layer without tension
- Apply Rissan around circular parts in layers

Butt-joint (wood-based panel material)



- Apply Rissan along the center of the joint



- Press it on with a hard rubber roller which improves the immediate adhesion



SIGA-house-tight

Vapor control layer or wood-based panel materials

Primur® Roll high-performance adhesive for stucco

Inside and outside



Item no. 3540-1208, Box: 10 rolls
Roll: width x thickness x length:
12 mm x 4 mm x 8 m / 0.47" x 0.16" x 26 ft

- ✓ extremely high adhesive strength without drying time
indoor and outdoor joints can be subjected to loads immediately
- ✓ apply Primur Roll before mounting the vapor control layer
clean and 50 % less working time
- ✓ constantly 4 mm thick and elastic
reliably absorbs structural movements

The bond must not be under standing water.
Primur can be painted over.
Keep out of reach of children!

Tips and tricks

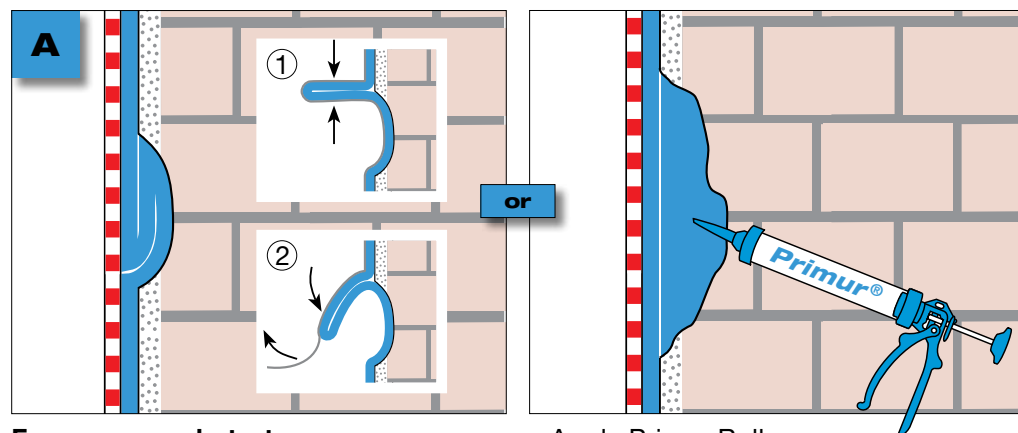

For uneven substrates

- Make a loop in the bead ① and fill unevenness airtight ②
- Apply Primur Roll
- Then fill the unevenness airtight using the Primur tubular bag

Airtightness

SIGA

Stucco

01 Apply bead before mounting the vapor control layer



Apply bead after mounting the vapor control layer



or

Clean the substrate

- Apply Primur, align and press it down
- Cut with a knife and press on

For the Outside,
see page 58



- Remove backing strip

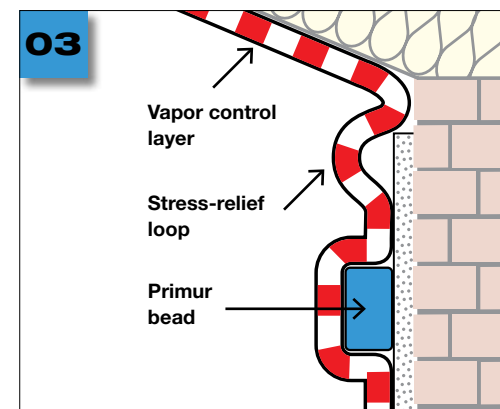

- Make a stress-relief loop in the vapor control layer

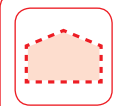

Stucco



- Press Majpell **firmly** onto Primur bead without creases or tensions



For overlaps:

- Apply a short bead of Primur (about 4") to Majpell at the overlap

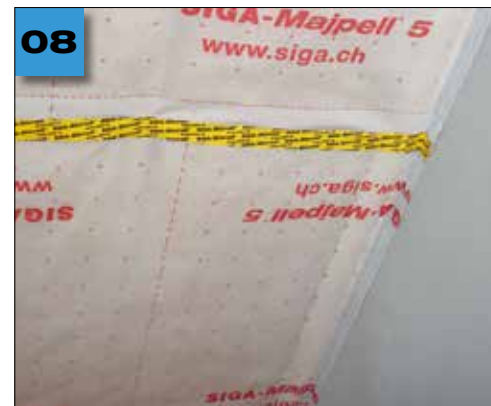

This is what it should look like:

- Majpell is airtightly sealed against stucco with Primur Roll



- Mount second sheet, press it on



- Seal the overlap with Sicrall, see page 15

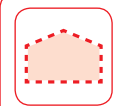

SIGA-house-tight

Vapor control layer or wood-based panel materials

Primur tubular bag / cartridge

high-performance adhesive
for stucco

**For inside
only**



- ✓ durably elastic
reliably absorbs structural movements
- ✓ durably self-adhesive
no supporting lath required
- ✓ solvent-free
unlimited durability,
resistant to ageing

	Tubular bag	Cartridge
Item no.:	3520	3510
Box:	12 bags + 5 nozzles	12 cartridges
Content:	600 ml/ 20.29 fl oz	310 ml/ 10.48 fl oz
Coverage:	12 – 16 m/ 39 – 52 ft	6 – 8 m/ 19 – 26 ft

Container made of PP, no aluminium
100 % recyclable

Primur can be painted over.
Keep out of reach of children!

Tips and Tricks



With the SIGA tubular bag applicator gun:

- Twin-spiked nozzle opens Primur bag
- Transparent tube shows fill level



With the SIGA cartridge applicator gun:

- Sturdy applicator gun with long-lasting professional quality
- With drip stop – hands and gun remain clean

Airtightness

SIGA

Stucco

01 Wet method



- Apply an 1/3" Primur bead
- Release secured vapor control layer immediately

02

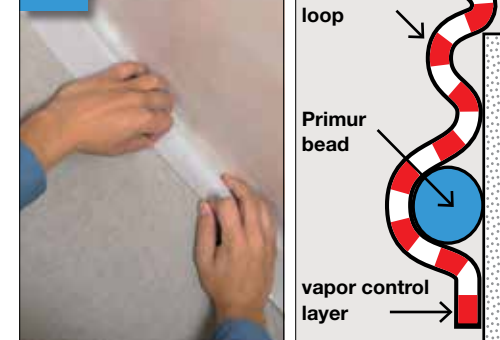

- Make a stress-relief loop in the vapor control layer
- **Gently** press vapor control layer onto Primur bead – **do not press flat!!**
- Primur bead **must remain at least 1/6"**

01 Dry method

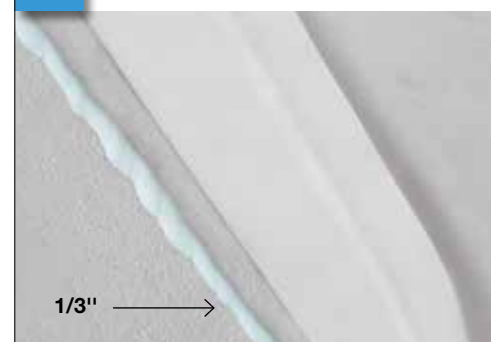

- Apply 1/3" Primur bead and allow it to dry for approximately **1 to 3 days**

02

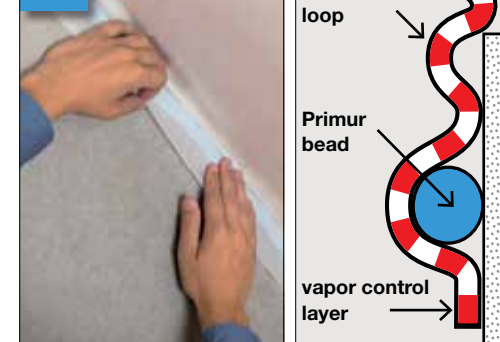

- Make a stress-relief loop in the vapor-control layer
- Press vapor control layer **firmly** onto the Primur bead without tension or wrinkles



SIGA-house-tight

Vapor control layer or wood-based panel materials

Corvum® 30/30

high-performance tape for angular penetrations, purlins, inside and outside corners and skylights



- ✓ pre-folded 30/30 mm
precise and secure in corners
- ✓ 1 backing strip already removed
simple and quick bonding
- ✓ 1 backing strip protruding
easy to remove

Item no. 5200-303025, Box: 10 rolls,
roll: width x length: 30/30 mm x 25 m / 1.2/1.2" x 82 ft
Special reinforced paper: splash-water resistant

Europ. Patent 1508436 + 1508648
US Patent 7,445,828 B2

Tips and Tricks

A



Using the backing strip for simple and quick application:

- **First** fold back the end of the backing strip, this way, the backing strip is ready to hand and can be quickly removed later
- **Then** apply Corvum to fit

Airtightness

SIGA

Angular penetration

01



- Cut Corvum to length: add about 1" at each end
- Bond tightly into corner for joists (with folded edge against joist)
- Remove the backing strip
- Unfold, press on

02



- Cut into the excess bisecting the angle
- **Start cut just short of the corner of the joist!**

03



- Repeat on each side of the joist

04



How it should look:

- Joist permanently airtight sealed with Corvum 30/30

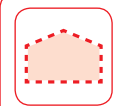

Purlin



- Bond Corvum accurately to the purlin below the rafters with the pre-folded edge at the top
- Press on firmly



- Successively remove backing strip and bond vapor control layer to Corvum
- Press on firmly



- Bond vapor control layer to rafters (see Twinet page 13) or staple it on

**How it should look:**

- The purlins have been airtightly bonded with Corvum 30/30

Inside corner



- Unfold a short piece of Corvum
- Make a cut in center of side **without backing strip**
- Fold over at a 90° angle
- Bond together

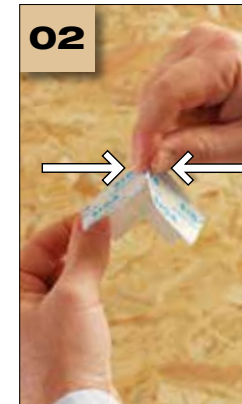

- Prefold to fit tightly into corner
- Fold back backing strip



- Stick down Corvum corner and press on well
- **Repeat** first in every inside corner



- **Then** connect the inside corners:
- Position Corvum accurately in corner and bond side without backing strip first, pressing on firmly, see tip A page 24
- Remove backing strip and press on



Outside corner



- Affix Corvum to wall with folded edge flush against outside edge
- Add about 1" at each end and cut off



- Remove backing strip
- Unfold



- Cut into the corner from the inside out approximately bisecting the angle
- **Start cut just short of corner!**



- Fold around outside corner
- Press it on



- Repeat on each side



- Fit a short piece of Corvum into corner
- Remove backing strip
- Press on
- Repeat on each side



How it should look:

- Outside corner is permanently airtight sealed with Corvum 30/30

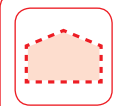

Skylight



- Cut vapor control layer



- Cut vapor control layer sheet to reveal depth



- Affix Corvum to vapor control layer with the folded edge flush with the sheet edge
- Press it on



- With the backing strip folded back insert Corvum accurately into the groove, **affix Corvum all the way to the corner**
- Successively remove backing strip
- Press it on



- Mount the remaining vapor control layer sheets: Cut sheet to size
- Affix Corvum with the folded edge flush with the sheet edge on three sides



- With the backing strip folded back insert Corvum accurately into the groove
- **Affix Corvum all the way to the corner**
- Successively remove backing strip
- Press it on



- Seal the sides



- Cut out 90° angle pieces from 4 short pieces of Corvum

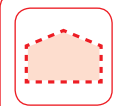

SIGA-house-tight

Vapor control layer or wood-based panel materials

Skylight



- Seal the corners



- Finally seal the overlaps using Sicral



How it should look:

- Skylight permanently airtightly sealed with Corvum 30/30 and Sicral 60



Prepare the skirt before installing the skylight. Advantages:

- No overhead work
- High safety
- Saves time

Airtightness

SIGA[®]

Corvum[®] 12/48 high-performance adhesive tape for window and door frames



- ✓ pre-folded 12/48 mm invisible behind cladding
- ✓ 1 backing strip already removed simple and quick bonding
- ✓ 1 backing strip protruding easy to remove

Item no. 5200-124825, Box: 10 rolls,
roll: width x length: 12/48 mm x 25 m / 0.47/1.89" x 82 ft
Special reinforced paper: splash-water resistant

Europ. Patent 1508436 + 1508648
US Patent 7,445,828 B2

Tips and Tricks



Using the backing strip for simple and quick application:

- **First** fold back the end of the backing strip, this way, the backing strip is ready at hand and can be quickly removed later
- **Then** apply Corvum to fit

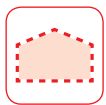

Recessed window and door frame



- Cut off a short piece, unfold
- Make a cut in the center of side without backing strip



- Fold over at a 90° angle
- Bond together
- Make a corner crease



- Remove backing strip



- Press into inside corner
- Affix 12 mm side of Corvum to window frame
- **First** repeat in each inside corner



- **Then** bond the inside corners:
- Stick the 12 mm side on to the frame
- Measure and cut to the correct length



- Remove backing strip
- Unfold
- Press on
- Repeat on each side

**How it should look:**

- Recessed window frame airtightly bonded with Corvum 12/48
- Corvum is invisible behind cladding

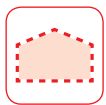

SIGA-house-tight

Vapor control layer or wood-based panel materials

Protruding window and door frame



- Measure off required length
- Add approx. 1" at each end



- Cut into the corner bisecting the angle
- Fold over
- Press on
- Repeat on each side



How it should look:

- Protruding window frames are airtightly bonded with Corvum 12/48

Airtightness

SIGA[®]

Vapor control layer for blown-in insulation



- ✓ tested system for blown-in insulation
safety with Majpell 5
- ✓ simple and easy installation with Twinet
saves time
- ✓ airtight pasting-over of injection holes with Sicrall 170
precise



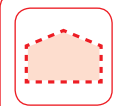

Vapor control layer for blown-in insulation



- Prepare rafter bottom side with Twinet to prevent uncontrolled filling of neighbouring field
- **Attention:** Twinet is not designed for permanent carrying of the insulation material weight



- Prepare wall joint using Primur Roll (see page 18)



- install Majpell 5, **press firmly onto Twinet**
- with the smooth side and the lettering facing you
- overlap sheets by about 4"



- Seal Majpell 5 airtightly using Sicrall, Rissan, Primur or Corvum (see page 14 – 32)



05 crosswise to the supporting structure



longitudinally to the supporting structure

or

- **Before injecting the insulation material:** screw battens on to the structure (to carry the insulation material weight)



06

- make a crosswise cut
- inject insulation material
- provide tight joists with an air outlet hole



07

- Paste injection hole over using Sicrall 170



08



- finally install interior cladding (protects against mechanical influences and UV radiation)

- further information about blown-in insulation will be found here www.sigacover.com or in our user folder
- ask your SIGA contact person if you have any technical questions
- use the blown-in insulation material always according to the manufacturer's instructions
- Installation of Majpell 5 with stapler: Staple distance $\leq 10 - 15 \text{ cm} / 4'' - 6''$
- Majpell 5 has been tested and released for blown-in insulation by:



Tips and tricks

A



In case of wide rafter fields:

- In case of crosswise installation of Majpell 5 the sealed overlaps can be reinforced by additional pieces of Sicrall crosswise to the overlap.

B



- We recommend (e.g. for flat roofs, wide space between rafters or extremely high insulation material weight) installation of the membrane in the direction of the rafters, sealing in the rafter area and longitudinal installation of the battens with screws.

Sicrall® 170

single-sided high-performance adhesive tape for injection holes



- ✓ 17 cm wide
airtight pasting-over of injection holes
- ✓ box with cutting gauge and built-in blade
quick and accurate cutting
- ✓ in dispenser box
roll is protected against dirt at all times

Item no. 4510-17040, Box: 1 roll,
roll: width x length: 170 mm x 40 m / 6.7" x 131 ft
Special reinforced paper: splash-water repellent,
hand-tearable

For permanently windtight sealing of injection holes and leaks in the exterior area, we recommend you use Wigluv 150.

Wood-based panels for blown-in insulation

01



- Pull out Sicrall 170
- Measure to the required length
- Tear over the blade

02



For wood-based panels (e.g. OSB)

- Press on with a hard rubber roller
- Improves instant bonding and is easy to use



SIGA-house-tight

Vapor control layer or wood-based panel materials

Rissan® 100 & 150

High-performance adhesive tape for bonding wall elements to the floor and ceiling



- ✓ extremely strong adhesion
reliable
- ✓ elastic
remains sealed despite structural movements
- ✓ slit backing strip
simple and quick to apply

	Rissan 100	Rissan 150
Item no.:	2510-10025	2510-15025
Box:	6 rolls	4 rolls
Roll:	100 mm x 25 m 3.9" x 82 ft	150 mm x 25 m 5.9" x 82 ft

Special, reinforced PE film, elastic.
The bond must not be under standing water

Dockskin® The high performance primer for sealing sandy, fibrous substrates



8.8 lb and
2.2 lb

- ✓ quick drying
short waiting time in combination with SIGA-Rissan®
- ✓ strong penetration
extremely good adhesion on soft woodfiber insulation boards, masonry and concrete
- ✓ usable on cold substrates
from -10° C / 14° F
solvent-free

	4 kg / 8.8 lb	1 kg / 2.2 lb
Item no.:	5920	5910
Box:	-	6 cans
Coverage:	Rissan 100: ~175 m / 574 ft Rissan 150: ~125 m / 410 ft	~35 m / 115 ft ~25 m / 82 ft

Solvent-free, water-based acrylate copolymer dispersion.
Shelf life: 18 months from the date of sale if unopened.
Clean the brush immediately with water.
Keep out of reach of children!

Airtightness

SIGA®

Base-joint

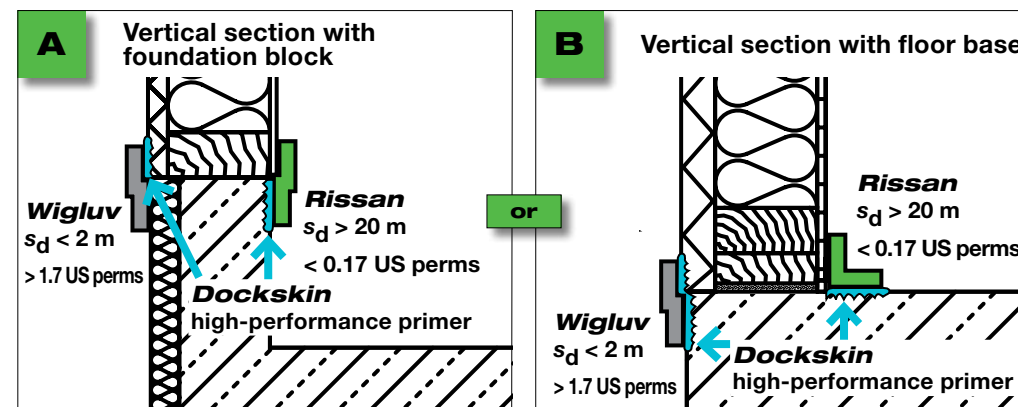

For the outside, see pages 69 and 77



- Shake **Dockskin** high-performance primer
- Apply a covering coat
- Wait until Dockskin is **transparent** and **sticky**.

- Apply Rissan in the middle, align
- Peel off the **slit backing strips** one after another, press down
- **Note:** make sure to apply sufficient Rissan on to the concrete and soft woodfiber insulation boards



Roof underlay membrane

Mounting



Overlap



Penetration



Skylight



Stucco



Mounting



Facade membrane

Mounting



Overlap



Penetration



Window



Base-joint





Visible facade membranes

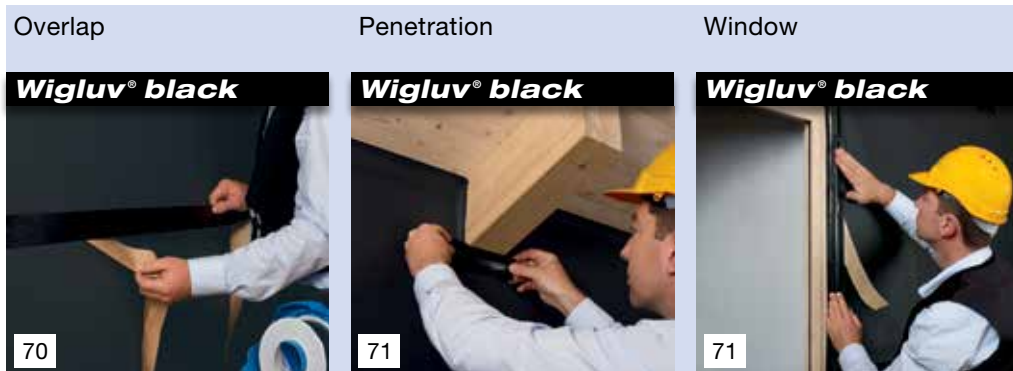

Soft woodfiber insulation boards

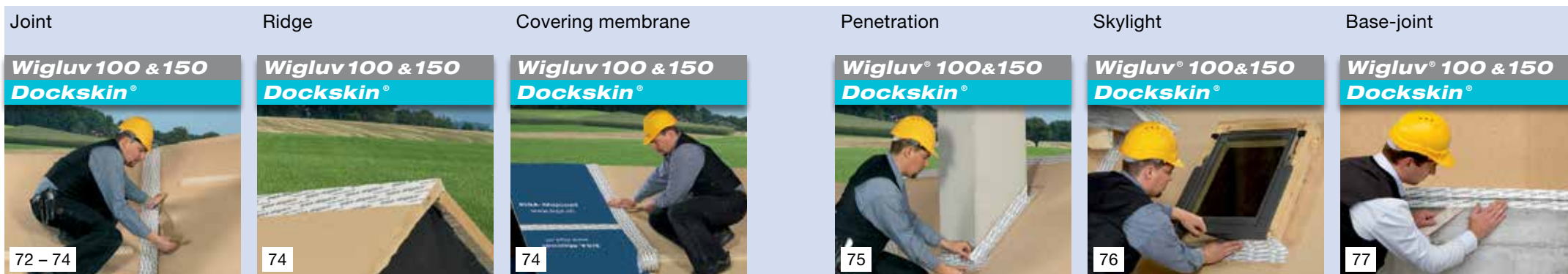



Making the building shell **windtight**

Use the following SIGA products for the reliable sealing of your windtight building shell:

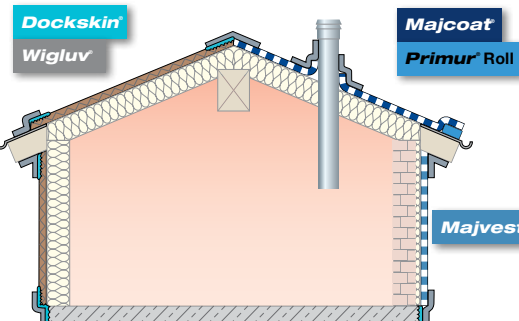

- The windtight building shell is created by the permanently sealed roof underlay membrane and facade membrane.
- If the shell is not windtight, cold outside air can cool down the insulation.
- Furthermore, snow, rain, insects and wood pests can enter the building unhindered and damage it.
- For this reason, the building owner is well advised to ensure his building is equipped with a continuously sealed windtight layer.

All critical areas must be sealed carefully to be windtight, e.g.:

- Overlaps between breathable membrane and facade membrane
- Circular and angular penetrations (e.g. chimneys, pipes, joists and skylights)
- Joints of underlay boards
- Transfer areas between covering membranes and underlay boards
- Base-joints

The US perm rate of the roof underlay membranes and facade membranes is higher than that for vapor control layers so that the moisture does not collect underneath the membrane. Here the following rule applies: the inside US perm rate must be at least ten times lower than the outside US perm rate.

Major thermal requirements and a wide range of substrates require high-quality products which bond reliably and permanently. SIGA offers you a comprehensive system with products which are perfectly designed to work well with one another. This way you can easily prevent building damage, when products are applied correctly!



Find out more about windtightness at www.sigacover.com

Roof underlay membrane

Majcoat® the roof underlay membrane

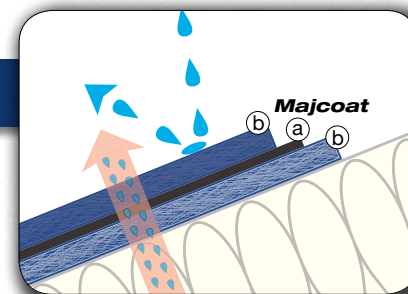

- ✓ **3-layer, sturdy and tear-proof**
no damage in construction phase
- ✓ **closed functional layer (a)**
protected by 2 fleeces (b)
driving rain-proof and durably moisture-diffusing
- ✓ **imprinted cutting and bonding aid**
saves time

Item no. 8710-150050

Roll: width x length: 1.5 m x 50 m = 75 m²
4.9 ft x 164 ft = 807 ft²

Weight: 16 kg / 35.27 lb

3 layered, monolithic functional layer, reinforced on both sides with PP nonwoven, thickness 0.6 mm / 0.023"
Weight per unit area: 190 g/m² / 0.62 oz/ft²
CE, EN 13859-1 / EN 13859-2
s_d value: 0.1 m
34 US perms

Atmospheric exposure: up to 4 months
Secure against driving rain, waterproof: far above W1 according to EN 1928
Fire behaviour: class E in accordance with EN 13501-1
The roof pitch must be at least 10 °

Tips and Tricks

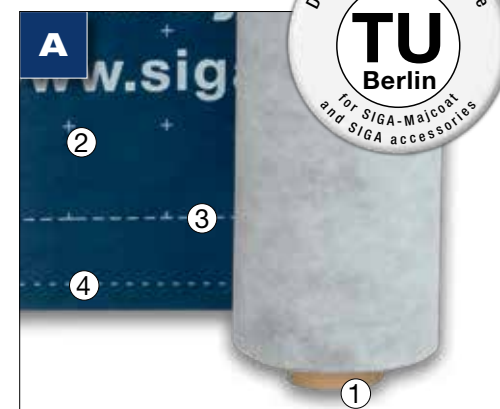

- **Protruding roll core (1)** protects Majcoat right up to the last meter/inch
- **Printed cutting (2), laying (3) and bonding aid (4)** saves time

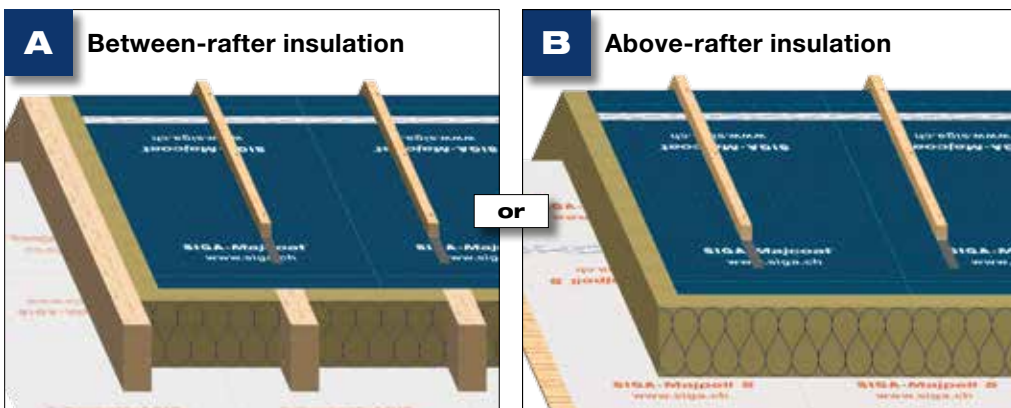

Mounting

**Suitable underlays for installation:**

Supporting structure, cladding, underlays (laid flush), heat insulation of sufficient pressure resistance



- Apply Majcoat with the printed side facing you
- When necessary make a stress-relief loop in the membrane (see page 53)



- Secure the membrane in the overlap area using a stapler



- Lay the second membrane
- Overlap the membranes by approx. 4" and secure them in the bonding area with a stapler



- Seal the membrane rainproof and windtight (see pages 53 – 59)
- When necessary seal overlaps with Wigluv 100 (see page 53)



- After sealing:**
- Stick the nail sealing tape to the counter batten and separate the backing strip (see page 60)

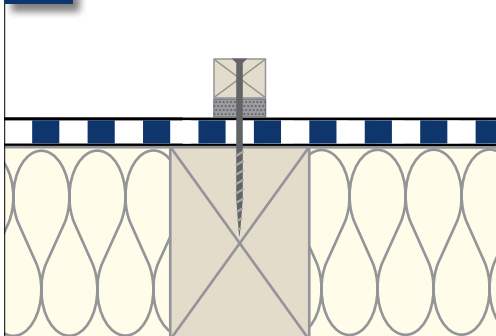

- Finally mount the breathable membrane by screwing or nailing the counter battens to a solid support (see page 52)

**A** Battens on supporting structure

- Mount counter battens in the direction of the supporting structure - directly on the supporting structure, e. g. rafters
- **Important:** counter battens must rest on the underlay with their complete surface

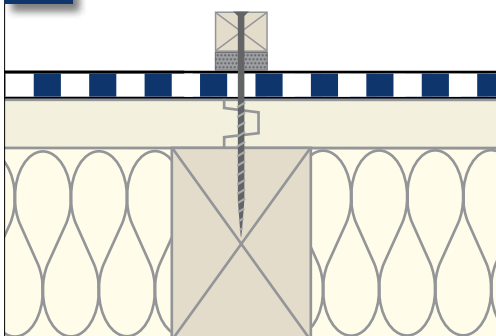
B Battens on boarding/breathable membrane

- Mount counter battens directly on boarding or underlays which have been laid flush

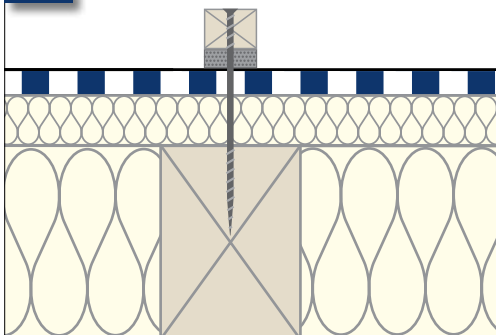
C Heat insulating layer between battens and supporting structure

- Mount counter battens using suitable screws (e. g. with full thread, under head thread)
- The heat insulation must feature sufficient pressure resistance
- If wood-based softboards are used these must be declared as underlay boards
- **Important:** water carrying layer must be at the same height at all points

Wigluv® 60

single-sided high-performance tape for overlaps, penetrations and windows



- ✓ high adhesive strength at high and low temperatures
reliable, no building damage
- ✓ vapor permeable > 1.7 US perms
prevents condensation build-up
- ✓ driving rain-proof and impermeable to water
permanent protection for roof and facade

Item no. 7510-6040, Box: 10 rolls,
roll: width x length: 60 mm x 40 m / 2.4" x 131 ft
Vapor permeable special PO film (> 1.7 US perms),
hand-tearable, elastic, impermeable to water,
UV-stable (12 months atmospheric exposure)

The bond must not
be under standing water.

Europ. Patent 1847577

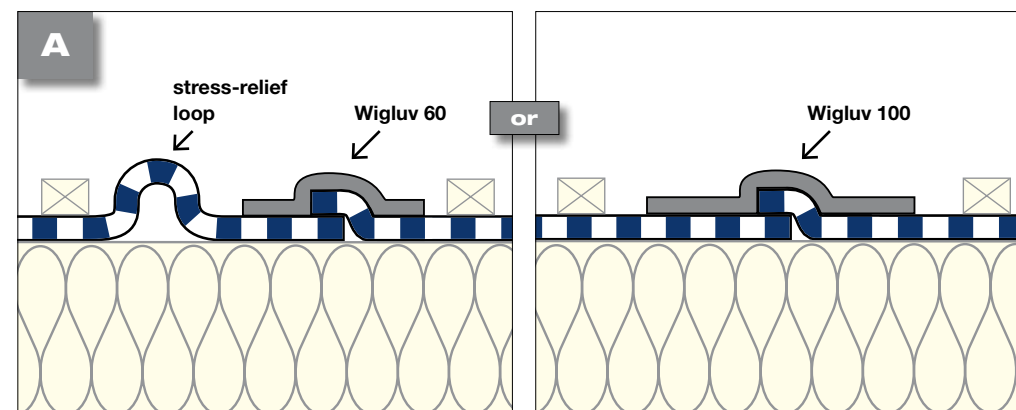
**Tips and Tricks**

- Membranes show different expansion and shrinkage characteristics
- **Make a stress-relief loop in the membrane** or seal overlaps with **Wigluv 100**, if:
 - membrane width > 4.9 ft or
 - the counter battens do not rest on the solid underlay with their complete surface or
 - the membrane is laid vertically or fully covers a pressure-resistant heat insulation

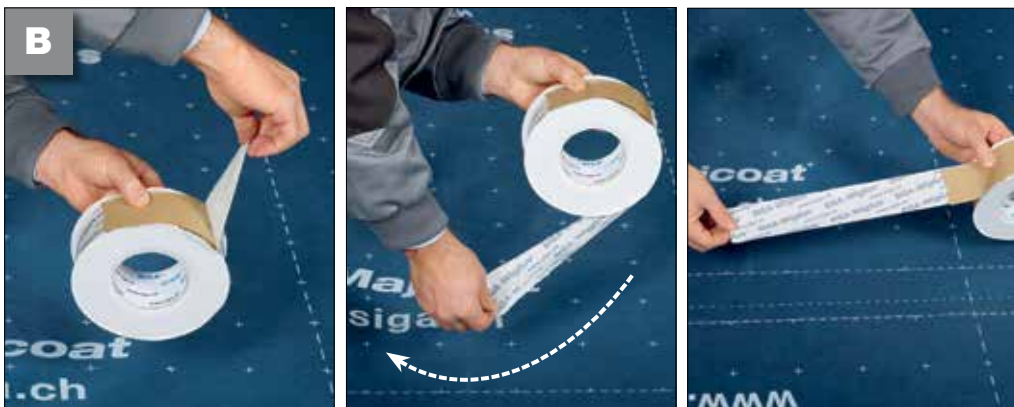

- Release Wigluv from its backing strip
- Unroll a turn of Wigluv so that the backing strip is at the top
- **Advantage:** backing strip separates automatically on unrolling

Overlap



- Align Wigluv centrally along the overlap and secure in place
- Bond without tension or wrinkles and press on firmly
- The printed bonding aid saves time

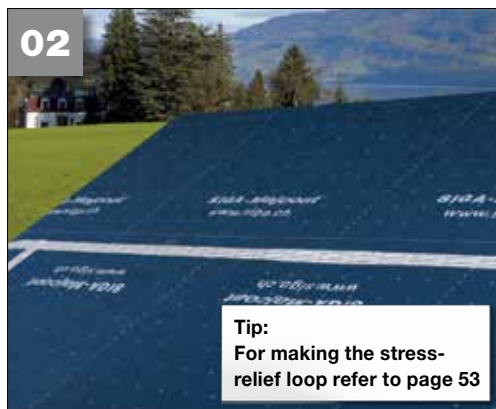

How it should look:

- The overlap is permanently sealed to make it windtight with Wigluv 60

Penetration



- Guide the membrane precisely around the circular penetration
- **Note: start sealing at the lowest point!**
Provides extra protection against water penetration



- Fix Wigluv half on the circular penetration then half on the membrane. Press down firmly
- Apply subsequent pieces in overlapping layers

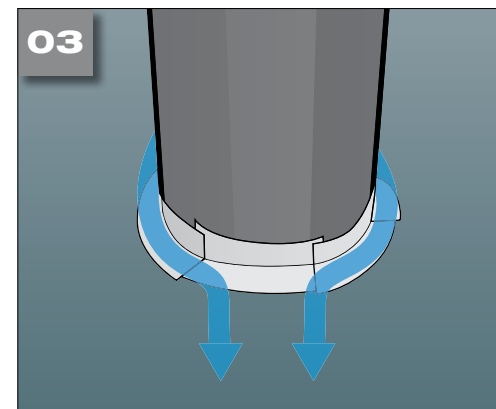

- Done, sealed in layers
- Water will reliably run off



How it should look:

- Circular penetration sealed windtightly in layers with Wigluv 60



Skylight

01



- Make a Y-cut in the membrane to the size of the installation frame (see cutting pattern)
- Fold back the sides

02



- Fit the skylight into the mounting frame
- Screw it on
- **Read and observe the instruction manual supplied by the skylight manufacturer!**

03



- Secure the membrane to installation and skylight frame on all sides

04



- Cut off approximately 1" in below the top of the skylight frame

05



- Seal the corners windtight with short pieces
- **Note: start sealing from the lowest point!** Provides extra protection against water penetration

06



- Seal the membrane all round the skylight frame so that it is windtight

07

**How it should look:**

- Skylight sealed windtightly with Wigluv 60
- Provide the penetration with extra protection with a deflection plate



SIGA-house-tight

Roof underlay membrane

Primur® Roll high-performance adhesive for stucco

Inside and outside



Item no. 3540-1208
Box: 10 rolls
Roll: width x thickness x length:
12 mm x 4 mm x 8 m / 0.47" x 0.16" x 26 ft

- ✓ extremely high adhesive strength without drying time
indoor and outdoor joints can be subjected to loads immediately
- ✓ apply Primur Roll before mounting the vapor control layer
clean and 50 % less working time
- ✓ constantly 4 mm thick and elastic
reliably absorbs structural movements

The bond must not be under standing water.
Primur can be painted over.
Keep out of reach of children!

Stucco



Example at a dormer:

- Clean the substrate and roof underlay membrane
- Apply Primur, align it and press it down
- Make a stress-relief loop in the membrane, press the sheeting down **firmly** without tension or wrinkles
- Cut off any excess sheeting



Example at a chimney:

For the Inside,
see page 19

Windtightness

SIGA

Wigluv® 100 & 150 high-performance tape for bonds, transfers and penetrations

Dockskin® the high performance primer for sealing sandy, fibrous substrates



- ✓ high adhesive strength at high and low temperatures
reliable, no building damage
- ✓ vapor permeable > 1.7 US perms
prevents condensation build-up
- ✓ slit backing strip
simple and quick to apply

	Dockskin	Wigluv 100	Wigluv 150
Item no.:	5920	7510-10025	7510-15025
Box:	-	6 rolls	4 rolls
Container/roll:	4 kg / 8.8 lb	100 mm x 25 m / 3.9" x 82 ft	150 mm x 25 m / 5.9" x 82 ft

Stucco

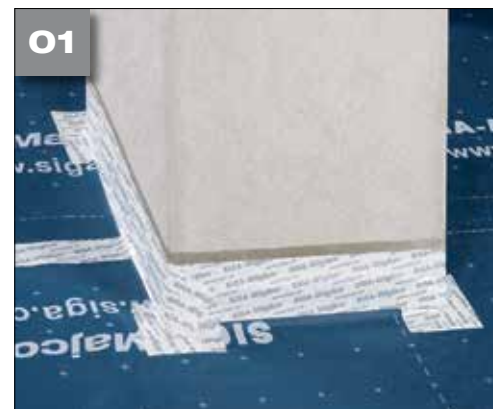

Example at a chimney:

- Bond the membrane with Dockskin and Wigluv 100 or Wigluv 150 to the masonry or plaster



SIGA-house-tight

Roof underlay membrane

Nail sealing tape II

for permanently rainproof sealing
when installing battens



- ✓ extremely adhesive on both sides
driving rain-proof, suitable for
makeshift coverage
- ✓ pre-installation on
counter batten
simple and quick application
- ✓ 4 mm thick special foam
reliable, no building damage

Item no. 2005-50430

Roll: width x thickness x length: 50 mm x 4 mm x 30 m / 2" x 0.16" x 98 ft

For roof pitches > 10°. Not recommended for PVC membranes.



Tips and Tricks

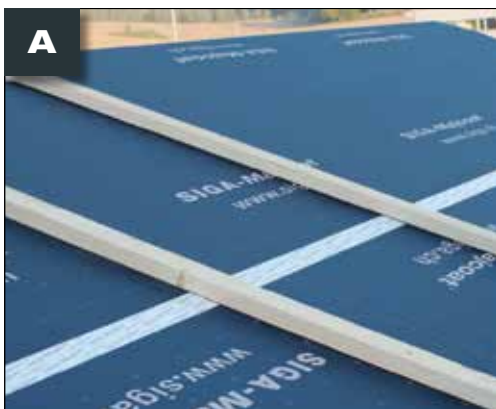

- Ideally with breathable membrane
SIGA-Majcoat



New
extremely sticky
on both sides

Windtightness

SIGA

Mounting



- Stick the nail sealing tape to the
counter batten



- Use backing strip for simple and quick
application
- Fold back the starting part of the
backing strip
- Backing strip is handy and can be
removed quickly later



- Align the counter batten with the
backing strip folded back on the
breathable membrane



- Separate the backing strip and press
the counter batten down



SIGA-house-tight

Roof underlay membrane

05



- Finally mount the breathable membrane by screwing or nailing the counter battens to a solid support (see page 52)

Facade membrane

SIGA[®]

Majvest[®] Facade membrane



- ✓ **3-layer, tear-proof and flexible**
can be laid easily, quickly and securely
- ✓ **3 m wide with cutting and bonding aid**
saves time
- ✓ **for all closed facades**
for all-purpose application

Tips and Tricks



- **Protruding roll core ①** protects Majvest right up to the last meter/inch
- **Printed cutting ②, laying ③ and bonding aid ④** saves time

Item no. 8910-300050
Roll: width x length: 3 m x 50 m = 150 m²
9.8 ft x 164 ft = 1614 ft²
Weight: 22 kg / 48.50 lb

3 layered, microporous functional layer, reinforced on both sides with PP fibre-fleece
Thickness: 0.5 mm / 0.02"
Weight per unit area: 130 g/m² / 0.43 oz/ft²
CE, EN 13859-2
s_d value: 0.05 m
68 US perms

Atmospheric exposure: up to 3 months
Waterproof: W1 in accordance with EN 1928
Fire behaviour: class E in accordance with DIN 13501-1

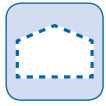

Mounting

A Rear-ventilated facades



01



- Apply Majvest with the printed side facing you

02



- Overlap the membrane by approx. 4"
- Secure the overlapping membrane in the bonding area with a stapler

03



After adhesion:

- For final attachment of the membrane mount counter slatting in **structure direction directly on the bearing structure**

Windtightness

Wigluv® 60 single-sided high-performance tape for overlaps, penetrations and windows



- ✓ high adhesive strength at high and low temperatures
reliable, no building damage
- ✓ vapor permeable > 1.7 US perms
prevents condensation build-up
- ✓ driving rain-proof and impermeable to water
permanent protection for roof and facade

Item no. 7510-6040, Box: 10 rolls,
roll: width x length: 60 mm x 40 m / 2.4" x 131 ft
Vapor permeable special PO film (> 1.7 US perms),
hand-tearable, elastic, impermeable to water,
UV-stable (12 months atmospheric exposure)

The bond must not be under standing water.

Europ. Patent 1847577

Overlap

01



Tip:
For making the stress-relief loop refer to page 53

- Align Wigluv centrally along the overlap and secure in place
- Bond without tension and wrinkles and press on firmly

02



How it should look:

The overlap is permanently sealed windtightly with Wigluv 60



Penetration



- Cut Wigluv to size: add 1" to each end, secure in the corner, press it on
- Cut into the excess bisecting the angle
- **Start cut just short of the corner!**



- Fold over
- Press on



- Repeat at each side of the penetration

**How it should look:**

- The angular penetration is sealed windtightly with Wigluv 60

Window



- Fold Wigluv to form a corner
- Stick it precisely into the corner of the window
- Repeat all around

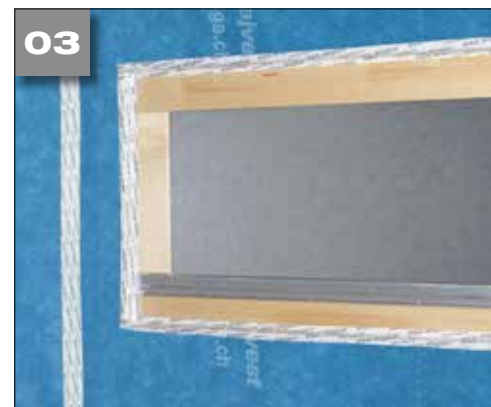

- To join the corners: cut Wigluv to the right length and position in the center of the corner
- Remove backing strip
- Press on

**How it should look:**

- The window is sealed windtightly with Wigluv 60



- When the cladding is installed



SIGA-house-tight

Facade membrane

Wigluv® 100 & 150

high-performance tape for bonds, transfers and penetrations

Dockskin®

the high performance primer for sealing sandy, fibrous substrates



- ✓ high adhesive strength at high and low temperatures
reliable, no building damage
- ✓ vapor permeable > 1.7 US perms
prevents condensation build-up
- ✓ slit backing strip
simple and quick to apply

	Dockskin	Wigluv 100	Wigluv 150
Item no.:	5920	7510-10025	7510-15025
Box:	-	6 rolls	4 rolls
Container/roll:	4 kg / 8.8 lb	100 mm x 25 m / 3.9 in x 82 ft	150 mm x 25 m / 5.9 in x 82 ft

or

Primur® Roll

Inside and outside



Item no. 3540-1208
Box: 10 rolls
Roll: width x thickness x length:
12 mm x 4 mm x 8 m / 0.47" x 0.16" x 26 ft

Wigluv® 60



Item no. 7510-6040, Box: 10 rolls,
roll: width x length: 60 mm x 40 m / 2.4" x 131 ft
Diffusion open special PO film (> 1.7 US perms),
hand-tearable, elastic, impermeable to water,
UV-stable (12 months atmospheric exposure)
Europ. Patent 1847577

Windtightness

SIGA

Base-joint

A Concrete



- Bond the concrete base-joint with high-performance primer Dockskin
- Align Wigluv 100 or Wigluv 150 to the center of the joint, secure in place
- Remove backing strip
- Bond without any tension and wrinkles and press on firmly

B Rigid insulation



- Align Wigluv 100 or Wigluv 150 to the center of the joint, secure in place
- Remove backing strip
- Bond without any tension and wrinkles and press on firmly

For the Inside,
see page 43

C Concrete



- The concrete must be dustless
- Apply Primur, align it and press it down
- Remove backing strip
- Bond with any tensions or wrinkles and press on **firmly**

D Metals



- Align Wigluv 60 to the center of the joint, secure in place
- Remove backing strip
- Bond with any tensions or wrinkles and press on firmly



Wigluv® black single-sided high-performance tape for overlaps, penetrations and windows



Item no. 7509-6040, Box: 10 rolls,
roll: width x length: 60 mm x 40 m / 2.4" x 131 ft
Vapor permeable special PO film (> 1.7 US perms),
hand-tearable, elastic, impermeable to water,
UV-stable (atmospheric exposure of 12 months)

- ✓ extremely UV-stable
highly resistant to ageing on
black facade membranes
- ✓ high adhesive strength at high
and low temperatures
reliable, no building damage
- ✓ vapor permeable > 1.7 US perms
prevents condensation build-up

The bond must not be under standing water.

Europ. Patent 1847577

Overlap



- Align Wigluv black centrally along the overlap and secure in place
- Remove backing strip
- Secure without tension and wrinkles
- Cut with a knife and press on



How it should look:

- The overlap on a visible facade is permanently secured windtightly with Wigluv black

Penetration



- Secure the penetration, such as pipes and joists, windtightly with Wigluv black
- For circular penetrations, see page 55



How it should look:

- The penetration is sealed windtightly with Wigluv black

Window



- Cut Wigluv black to the right length and position in the corner
- Remove backing strip and press on
- Repeat on each side



How it should look:

- The window next to a visible facade is sealed windtightly with Wigluv black



SIGA-house-tight

Soft woodfiber insulation boards

Wigluv® 100 & 150

High-performance tape for bonds, transfers and penetrations



- ✓ **high adhesive strength at high and low temperatures**
reliable, no building damage
- ✓ **vapor permeable > 1.7 US perms**
prevents condensation build-up
- ✓ **slit backing strip**
simple and quick to apply

	Wigluv 100	Wigluv 150
Item no.:	7510-10025	7510-15025
Box:	6 rolls,	4 rolls
Roll:	100 mm x 25 m 3.9" x 82 ft	150 mm x 25 m 5.9" x 82 ft

vapor permeable special PO film (> 1.7 US perms), hand-tearable, elastic, impermeable to water, UV-stable (atmospheric exposure of 12 months), the seal must not be under standing water. Europ. Patent 1847577

Dockskin® The high performance primer for sealing sandy, fibrous substrates



8.8 lb and 2.2 lb

- ✓ **quick drying**
short waiting time in combination with SIGA-Wigluv®
- ✓ **strong penetration**
extremely good adhesion on soft woodfiber insulation boards, masonry and concrete
- ✓ **usable on cold substrates**
from -10° C/ 14° F
solvent-free

	4 kg / 8.8 lb	1 kg / 2.2 lb
Item no.:	5920	5910
Box:	-	6 cans
Coverage:	Rissan 100: ~175 m / 574 ft Rissan 150: ~125 m / 410 ft	~35 m / 115 ft ~25 m / 82 ft

Solvent-free, water-based acrylate copolymer dispersion. Shelf life: 18 months from the date of sale if unopened. Clean the brush immediately with water. Keep out of reach of children!

Windtightness

SIGA®

Tips and Tricks



Requirements for secure bonding:

- The substrate must be sustainable, swept clean and free of ice. It must not be adhesive-repellent



To create extreme adhesion:

- Shake high-performance primer Dockskin
- Apply a covering coat (a)
- Wait until Dockskin is **transparent** and **sticky**. (b)

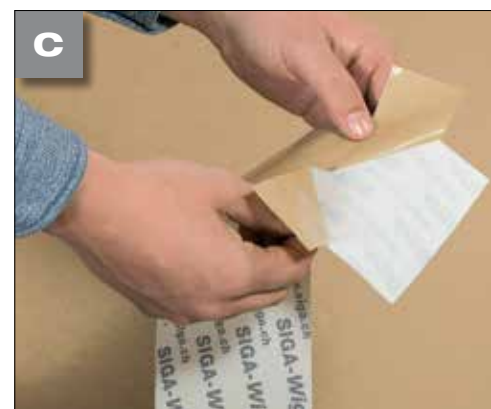

Quick and reliable

- Before applying, fold back both backing strips

**Joint**

- When priming with Dockskin, see tips A and B on page 73
- Apply Wigluv in the middle, align

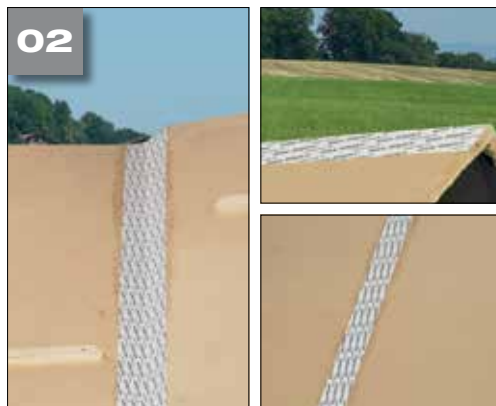
**How it should look:**

- Valley, ridge and joint are sealed windtightly with Dockskin and Wigluv 100 or 150

Covering membrane

- When priming woodfiber board with Dockskin, see tips A and B on page 73
- Apply Wigluv in the middle, align
- Remove both backing strips simultaneously, press on

**How it should look:**

- The transition area between the covering membrane and the woodfiber board is sealed windtightly with Dockskin and Wigluv 100

Penetration

- When priming with Dockskin, see tips A and B on page 73
- **Starting at the bottom and working upwards**, cut Wigluv at both ends with approx. 2" excess
- Bond half of Wigluv onto the penetration and then half onto the woodfibre board



- Cut into the excess bisecting the angle and fold over
- **Cut just short of the corner!**

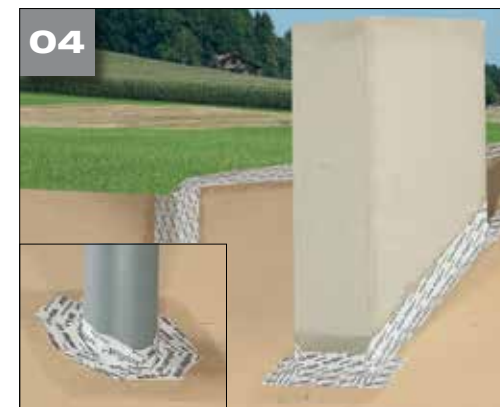

- Repeat on each side, **from bottom to top**

**How it should look:**

- The penetration is sealed windtightly with Dockskin and Wigluv 100

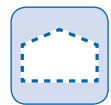

Skylight



- When priming with Dockskin, see tips A and B on page 73
- **Starting at the bottom and working upwards:** cut Wigluv to correct length with approx. 2" excess at both ends
- Bond half of Wigluv onto the penetration and then half onto the woodfibre board



- Cut into the excess bisecting the angle and fold over
- **Start cut just short of the corner!**



- **Starting at the bottom and working upwards:** repeat on each side

**How it should look:**

- The skylight is sealed windtightly with Dockskin and Wigluv 150

Base-joint

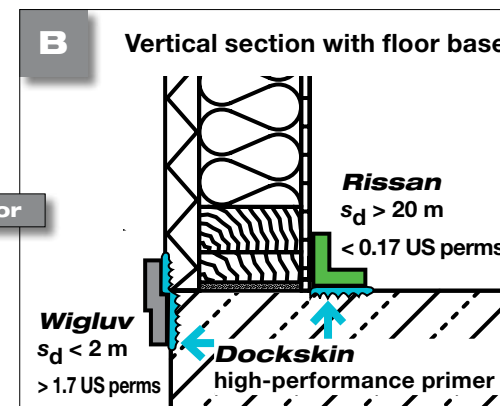
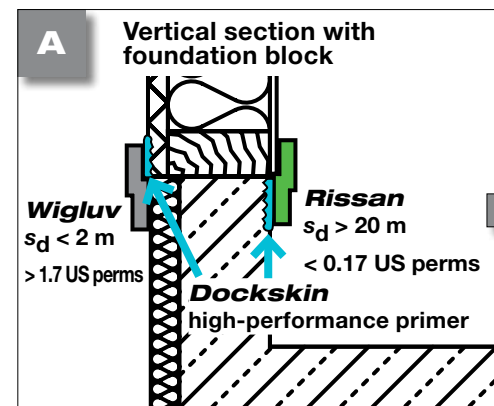

or

For the Inside,
see page 43

- Shake high-performance primer Dockskin
- Apply a covering coat
- Wait until Dockskin is **transparent** and **sticky**.



- Apply Wigluv in the middle, align
- Peel off the slit backing strips one after another, press down
- **Note:** make sure to apply sufficient Wigluv on the concrete and soft woodfiber insulation boards

SIGA products at your local dealer

- ✓ Available as individual rolls or in boxes
- ✓ Clearly arranged and ready to take with you
- ✓ Self-explanatory packaging



Discover lots of valuable information
at www.sigacover.com



- ▶ Find out in the product house in which areas SIGA products are used
- ▶ Benefit from animated infographics and detailed representations
- ▶ Visit www.sigacover.com and get your professional knowledge



- ✓ Application films
- ✓ Instructions for use
- ✓ Blower door test
- ✓ Safety data sheets
- ✓ Specification texts
- ✓ SIGA comic
- ✓ Specialist dealer database

Enlighten your customers!

The SIGA comic informs building owners and architects about energy-saving building shells

With the SIGA-Comic

- ✓ your customers recognize the great importance of airtightness
- ✓ you save consultation time
- ✓ new customers demand your services



01



- ▶ Order SIGA comics **free of charge** at www.sigacover.com

02



- ▶ Stamp the SIGA comic with your company address!

03



- ▶ Enclose the SIGA comic with your quotations or give it to your customers personally!

Protect your work!

When the electrician comes to the building site the airtight layer is at risk!

With the SIGA warning sticker

- ✓ you protect your work against damage caused by others
- ✓ you stand out as a professional in airtight sealing
- ✓ you make a positive impression on building owners and architects and advertise your perfect work



01



- ▶ Order SIGA warning stickers **free of charge** at www.sigacover.com

02



- ▶ Apply SIGA warning stickers visibly onto the airtightly sealed vapor control layer!

03



- ▶ Leave a SIGA comic for the electrician so that he knows about airtightness!

Warranty

SIGA grants on all properties guaranteed in the instruction manual.

However, SIGA excludes any liability for processing or use that does not comply with the instructions, or:

- unusual influences, in particular of a chemical or mechanical nature
- if permanent mechanical strain (e.g. due to tensile and compression forces) has an impact on the seal
- multilayered sheeting or panelling materials without sufficient cohesive strength
- if windtight sealing is performed on a roof pitch of $< 10^\circ$
- in the case of open cladding with Majcoat / Majvest
- in the case of airtight sealing in sauna and swimming pool applications
- when using Dockskin, if the sealing is not applied with Wigluv, Rissan, Sicrall, Corvum, Primur, Twinet
- when the prerequisites for the secure laying of sheeting are not fulfilled:
The substructure must be free of any protruding objects which could cause injury, such as screws etc.
- when the prerequisites for reliable sealing are not fulfilled:
The substrate must be dry, sustainable and free of any dirt and grease. It must not be adhesive-repellent. Before sealing, clean the substrate and sheeting and perform an adhesion test on site. If necessary, strengthen with high-performance primer SIGA-Dockskin.
Caution! The bonds must not be under standing water. Creases or tensions in the sheeting / tape must be relieved by cutting and resealed.

THE FOREGOING WARRANTY IS EXPRESSLY MADE IN LIEU OF ANY AND ALL OTHER WARRANTIES, WHETHER EXPRESS OR IMPLIED, INCLUDING THE WARRANTIES OF MERCHANTABILITY, FITNESS FOR A PARTICULAR PURPOSE OR NONINFRINGEMENT, AND ANY AND ALL SUCH IMPLIED WARRANTIES ARE HEREBY EXPRESSLY EXCLUDED AND DISCLAIMED.

SIGA Early Warning System

Adjustments and new developments to commercially available surfaces, panels and membranes are systematically recorded thanks to the unique SIGA Early Warning System and regularly flow into the further development of SIGA products.

Therefore, you should arrange for a regular inventory turnover to ensure that you always have SIGA products that are state-of-the-art in terms of technology and ecology.

Manual

This manual can become invalid if new knowledge is acquired or new developments are made. The currently valid manual is available at www.sigacover.com

Technical details

Adhesive

SIGA high-performance adhesives are free of solvents, VOC, high boilers, plasticisers, chlorine and formaldehyde. They cannot be removed.

Application temperature

From -10°C / 14°F

Primur cartridge and tubular bag: from $+5^\circ\text{C}$ / 41°F

Temperature resistance

-40°C to $+100^\circ\text{C}$ / -40°F to 212°F

Age resistance

Durable adhesive strength; made without rubber, resins or solvents to prevent embrittlement.

Storage

Store in a **cool, dry place** in its original box.

Store Primur cartridge, Primur tubular bag, and Dockskin in a cool, dry and **frost-protected** place in their original boxes.

Store Majpell, Majcoat, and Majvest in a cool, dry and **UV-protected** place.

Developed and manufactured by: © SIGA

For different substrates the right SIGA high-performance adhesive

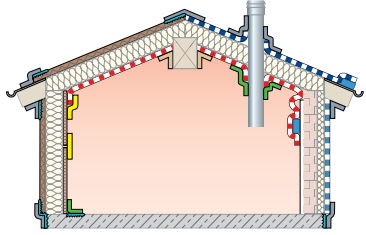

	Twinet®	Rissan® 60	Rissan® 100	Rissan® 150	Sicrall® 60	Sicrall® 170	Corvum® 30/30	Corvum® 12/48	Primur® Cartridge	Primur® Tubular bag	Primur® Roll	Wigluv® black	Wigluv® 60	Wigluv® 100	Wigluv® 150
Wood	✓	✓	✓	✓			✓	✓	✓	✓	✓	✓	✓	✓	✓
Hard wood-based panel materials	✓	✓	✓	✓		✓	✓	✓	✓	✓	✓	✓	✓	✓	✓
Soft woodfiber insulation boards													✓*	✓*	
Gypsum fiberboards	✓	✓	✓	✓	✓	✓	✓	✓	✓	✓	✓		✓	✓	✓
Plasterboards	✓	✓	✓	✓	✓	✓	✓	✓	✓	✓	✓				
Cement fiberboards	✓	✓	✓	✓			✓	✓	✓	✓	✓	✓	✓	✓	✓
Concrete, masonry, plaster	✓*		✓*	✓*					✓	✓	✓	✓*		✓*	✓*
Bituminous sheeting in the base area			✓	✓					✓	✓	✓			✓	✓
Rigid insulation (EPS/XPS/PU)			✓	✓										✓	✓
Metals	✓	✓	✓	✓			✓	✓			✓	✓	✓	✓	✓
Hard plastics	✓	✓	✓	✓			✓	✓			✓	✓	✓	✓	✓
Electric cables		✓	✓	✓								✓	✓	✓	✓

* must be reinforced with SIGA-Dockskin high-performance primer

If necessary, strengthen all above mentioned substrates with high performance primer SIGA-Dockskin.

For different SIGA membranes the right SIGA high-performance adhesive

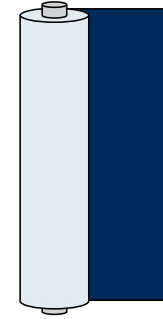

	Twinet®	Rissan® 60	Rissan® 100	Rissan® 150	Sicrall® 60	Sicrall® 170	Corvum® 30/30	Corvum® 12/48	Primur® Cartridge	Primur® Tubular bag	Primur® Roll	Wigluv® black	Wigluv® 60	Wigluv® 100	Wigluv® 150
SIGA Majpell 5	✓	✓	✓	✓	✓	✓	✓	✓	✓	✓	✓				
SIGA Majcoat											✓		✓	✓	✓
SIGA Majvest	✓										✓	✓	✓	✓	✓

SIGA Cover Inc.'s General Terms and Conditions of Sale and Delivery

1. General

These General Terms and Conditions of Sale (these "Terms") govern the sale and delivery of all products (the "Products"), and all transactions incidental thereto, by or on behalf of SIGA Cover, Inc. ("SIGA") to any of its customers (each, "Customer").

No other terms or conditions shall be of any effect unless otherwise specifically agreed upon by SIGA in a writing duly executed by SIGA. Any additional or different terms or conditions contained in Customer's order or response to SIGA's confirmation shall be deemed objected to by SIGA and shall not be binding on SIGA. No general terms and conditions of Customer shall at any time form a part of the content of any contract or agreement between the Customer and SIGA, even if they are not expressly rejected by SIGA.

These Terms supersede any and all prior oral quotations, communications, agreements or understandings of the parties in respect of the sale and delivery of the Products and shall supersede any and all other terms and conditions contained in any order placed by Customer otherwise communicated by Customer.

Failure of SIGA to object to terms and conditions communicated by Customer shall in no event be construed as an acceptance of any other terms and conditions. Any communication or conduct of Customer which confirms an agreement for the delivery of Products by SIGA, as well as acceptance in whole or in part by Customer of any delivery of Products from SIGA shall constitute an unqualified acceptance by Customer of these Terms.

If Customer finds any Term not acceptable, Customer must so notify SIGA immediately and must reject the Products delivered under these Terms. Deviations from these Terms require the written approval of SIGA.

2. Offers, Orders and Confirmation

SIGA shall sell and deliver to Customer, and Customer shall purchase and accept from SIGA, the Products described on or in any order, agreement or quotation, or any combination thereof (an "Order"). All offers made by SIGA are revocable and subject to change without notice to Customer, SIGA shall be entitled to refuse an Order for any or no reason.

No Order is binding upon the SIGA until the earlier to occur of SIGA's acceptance of the Order in writing or the delivery of the Products to the Customer (a "Confirmed Order"). Notwithstanding any prior confirmation of an Order by SIGA, SIGA shall have no obligation to deliver Products to Customer or otherwise perform any of its obligations set forth in the Confirmed Order or herein if Customer is in breach of any of its obligations hereunder or the Confirmed Order.

In the event Customer cancels or modifies any Confirmed Order, Customer shall bear all costs associated with such cancellation or modification, and, in the event of a modification of a Confirmed Order, SIGA shall be free to accept or reject such modification without any further obligation to Customer whatsoever.

Each Confirmed Order shall be considered a separate agreement between the parties to purchase and sell Products, and any failure to deliver Products under any Confirmed Order shall have no consequences for other deliveries. The terms and conditions of a Confirmed Order and those specified herein taken together shall constitute the entire agreement between SIGA and Customer regarding the sale and delivery of the Products pursuant to such Confirmed Order.

3. Prices

The price of the Products shall be as published in SIGA's current price list in effect at the time of the Order unless otherwise quoted in writing by SIGA. A price list is available on request. Unless otherwise agreed by SIGA in writing, all prices set forth in such price list are subject to change without prior notice.

Unless otherwise agreed in writing by SIGA, SIGA's prices shall be EX WORKS (per Incoterms 2010) [Olympia, WA] and include standard packaging but not sales or use tax or any other similar applicable federal, state or foreign taxes, duties, levies or charges in any jurisdiction levied in relation to the Products or the delivery thereof ("Taxes"). The amount of any Taxes levied in connection with the sale of the Products to Customer shall be for Customer's account and, if SIGA is responsible for the collection thereof, shall either be added to each invoice or be separately invoiced by SIGA to Customer.

4. Payment Terms

Unless otherwise agreed in writing by SIGA, the purchase price for the Products to be delivered under a Confirmed Order and all other amounts due in connection therewith shall be due and payable prior to delivery of such Products. Customer shall make payment in US dollars by check or wire transfer to the account indicated on SIGA's invoice without any cash discount, deduction or offset whatsoever, and SIGA shall not be required to incur any expense to receive timely payment in full as required by these Terms. In no event shall any loss, damage, injury or destruction release Customer from its obligation to make the payments required herein.

With regard to payment of all amounts due to SIGA under any Confirmed Order, time is of the essence. If Customer fails to make payment on or before the due date for such payment, Customer shall pay interest to the SIGA at the rate of one and one-half percent (1.5%) per month or such lesser amount as may be permitted by applicable law. If Customer fails to observe these Terms or the terms of any other agreements between SIGA and Customer, or if Customer becomes insolvent, all balances then due and owing to SIGA shall become due immediately, notwithstanding any agreed-upon payment periods. All costs and expenses incurred by SIGA with respect to the collection of overdue payments (including, without limitation, reasonable attorney's fees, expert fees, court costs and other expenses of litigation) shall be borne by Customer. Every payment by Customer shall first be applied to pay for SIGA's cost of collection, then interest owed by Customer, and then to the oldest outstanding claim.

If SIGA extends credit to Customer for the purchase price for any Products or any other amounts due to SIGA, Customer hereby grants to SIGA as security for the timely payment and performance of all Customer's payment obligations to SIGA, a first priority security interest (the "Security Interest") in all Products heretofore or in the future delivered to Customer for as long as such Products shall not have been sold by Customer in the ordinary course of business (the "Collateral"). SIGA shall be entitled to file any and all financing, continuation or similar statements under the Uniform Commercial Code, and take any and all other action necessary or desirable, in SIGA's sole and absolute discretion, to perfect its security interest in the Collateral and

to establish, continue, preserve and protect SIGA's security interest in the Collateral. Customer agrees to take any and all actions and provide Customer with all information necessary to enable SIGA to perfect and enforce this security interest in all jurisdictions and vis-à-vis any of Customer's creditors. This security interest shall remain in force until payment in full of the entire purchase price for such Products and any other amounts due to SIGA by Customer.

SIGA may, without notice, change or withdraw extensions of credit at any time. If SIGA ceases to extend credit terms before shipment, Customer's sole remedy shall be cancellation of its Order.

5. Delivery and Acceptance

Unless otherwise agreed in writing by SIGA, all deliveries of Products shall be made EX WORKS (per Incoterms 2010) [Olympia, WA] and title to and risk of loss for the Products shall pass to Customer upon delivery thereof to any common carrier at SIGA's warehouse. SIGA or its agent may select any commercial air, ship, motor or rail carrier or any combination thereof for the transportation of the Products and will notify Customer thereof in the Order Confirmation. Any times or dates for delivery by SIGA are estimates and shall not be binding on SIGA. SIGA is entitled to deliver the Products to be delivered under any Confirmed Order in part and to invoice Customer separately for such partial deliveries. In no event shall SIGA be liable for any delay in delivery. Delay in delivery of any Products shall not relieve Customer of its obligation to accept delivery thereof.

Customer's failure to accept delivery of any Products pursuant to a Confirmed Order shall not release or excuse Customer from its obligation to timely pay all amounts due in connection with such Confirmed Order. If Customer rejects or revokes acceptance of Products or fails to pay any amounts when due, or repudiates with respect to all or part of a Confirmed Order, SIGA, in its sole and absolute discretion, may extend the period of delivery by such period as SIGA may deem reasonable, or withhold or cancel delivery of any Products, or cancel any or all Confirmed Orders without any further obligations to Customer whatsoever. In such event Customer shall be responsible for any and all costs and expenses incurred or damages or losses

SIGA Cover Inc.'s General Terms and Conditions of Sale and Delivery

suffered by SIGA in connection with any such delay notwithstanding any action or inaction by SIGA with regard to such delay.

6. Examination and Conformity to Order

Promptly upon receipt of any Products, Customer shall conduct a full and complete inspection of such Products and satisfy itself that the Products delivered conform with SIGA's warranties and meet all requirements set forth in the Confirmed Order. Customer shall notify SIGA in writing of any apparent defects or other non-compliance with such Confirmed Order that Customer could reasonably have discovered during such inspection within thirty (30) days from the date of receipt of such Products, and Customer shall notify SIGA in writing within five (5) days of the date on which Customer shall first have become aware of any hidden defect or non-compliance which could not reasonably have been discovered during Customer's initial inspection of the Products. Notwithstanding anything to the contrary contained herein, any and all claims for defective or non-compliant Products must be received by SIGA within six (6) months of the earlier to occur of (a) the delivery of the Products pursuant to these Terms or (b) SIGA's notification of Customer that the Products are ready for delivery.

If Customer fails to timely notify SIGA of any defects or non-compliance of any Products delivered or Customer uses, destroys or modifies any Products that Customer knows or should have known to be defective or non-compliant without SIGA's prior written consent, Customer shall be deemed to have unconditionally accepted such Products and waived all of its claims for breach of warranty or otherwise in respect of such Products.

Products that SIGA consents or directs Customer in writing to be returned shall be returned to SIGA at Customer's risk to the destination directed by SIGA.

7. Limited Warranty

SIGA solely warrants that on the date of delivery the Products shall conform to the specifications set forth in SIGA's specifications (unless changes or modifications were required to comply with applicable law, rules or regulations) and be free from defects in design, material and workmanship. If and to the extent Products fail to meet such warranty, SIGA may, following Customer's timely

notice pursuant to Section 6, in its sole and absolute discretion, within a reasonable time either repair or replace the Products at no charge to Customer, or issue a credit for such Products in the amount of the original net invoice price, and Customer's remedies shall be limited to the remedy selected by SIGA in accordance with this Section 7. SIGA's obligation to repair, replace, or credit shall be contingent upon receipt by SIGA of timely notice of any alleged non-conformance of Products and, if applicable, the return of the Products, in accordance with these Terms.

Unless expressly warranted in writing in any Confirmed Order, SIGA makes no warranty that the Products comply with applicable law, regulations or specifications in any jurisdiction in which the Products may be sold or marketed. Any governmental or other approvals necessary in connection with the sale, marketing, distribution or use of the Products shall be Customer's sole responsibility.

Failure to store, handle or use the Products in strict compliance with SIGA's instructions and warnings in effect from time to time and any modification of the Products shall void all warranty claims.

Customer shall not be authorized to make any warranties that are inconsistent with the foregoing warranty, and any and all such warranties shall in no way commit SIGA.

THE FOREGOING WARRANTY IS EXPRESSLY MADE IN LIEU OF ANY AND ALL OTHER WARRANTIES, WHETHER EXPRESS OR IMPLIED, INCLUDING THE WARRANTIES OF MERCHANTABILITY, FITNESS FOR A PARTICULAR PURPOSE OR NONINFRINGEMENT, AND ANY AND ALL SUCH IMPLIED WARRANTIES ARE HEREBY EXPRESSLY EXCLUDED AND DISCLAIMED.

8. Limitation of Liability

In no event shall SIGA be liable to Customer for any indirect, incidental, punitive, special or consequential damages, including but not limited to, damages for loss of profits, revenue, goodwill or use, whether in an action in contract, tort, strict liability, or imposed by statute, or otherwise, even if Customer was advised of the possibility of such damages.

SIGA shall not be liable for, and Customer assumes

responsibility and shall indemnify and hold SIGA harmless for, any and all claims, including without limitation claims for personal injury or property damages, resulting from the improper use or handling of the Products, alone or in combination with other products or equipment, or Customer's failure to properly communicate SIGA's instructions and warnings to users of the Product.

Notwithstanding any of the terms contained herein, SIGA's liability – whether based upon contract, tort, equity, negligence or any other legal concept – shall in no event exceed the value of the Confirmed Order. Customer hereby acknowledges and agrees that the provisions of these terms fairly allocate the risks between SIGA and Customer, that SIGA's pricing reflects this allocation of risk, and but for this allocation and limitation of liability, SIGA would not have entered into an agreement with Customer to sell Products to Customer.

In jurisdictions that limit the scope of or preclude limitations or exclusion of remedies or damages, or of liability, such as liability for gross negligence or willful misconduct or do not allow implied warranties to be excluded, the limitation or exclusion of warranties, remedies, damages or liability set forth above are intended to apply to the maximum extent permitted by applicable law. Customer may also have other rights that vary by state, country or other jurisdiction.

9. Miscellaneous

If any provision contained in these Terms or any Confirmed Order is held by final judgment of a court of competent jurisdiction to be invalid, illegal or unenforceable, such invalid, illegal or unenforceable provision shall be severed from the remainder of these Terms or such Confirmed Order, and the remainder of these Terms or such Confirmed Order shall be enforced. In addition, the invalid, illegal or unenforceable provision shall be deemed to be automatically modified, and, as so modified, to be included in these Terms, such modification being made to the minimum extent necessary to render such provision valid, legal and enforceable.

In the event of a violation or threatened violation of SIGA's proprietary rights, SIGA shall have the right, in addition to such other remedies as may be available pursuant to law or these Terms, to temporary or permanent injunctive relief enjoining such act or

threatened act. The parties acknowledge and agree that legal remedies for such violations or threatened violations are inadequate and that SIGA would suffer irreparable harm.

Customer may not assign its order or any right or interest therein or any other obligation arising hereunder without the prior written consent of SIGA.

SIGA's waiver of any breach or violation of these Terms or the provisions of any Confirmed Order by Customer shall not be construed as a waiver of any other present or future breach or breaches by Customer.

The parties hereto are independent contractors and nothing in these Terms will be construed as creating a joint venture, partnership, employment or agency relationship between the parties.

10. Applicable Law and Jurisdiction

These Terms and the Confirmed Orders shall be governed by and construed in accordance with the laws of the State of California without giving effect to any choice or conflict of law provision or rule that would defer to or cause the application of the substantive laws of any jurisdiction other than California.

Each Party hereby consents to personal jurisdiction in the State of California and agrees that any and all dispute arising out of or in connection with these Terms or any Order shall exclusively be submitted to the federal or state courts with jurisdiction in Irvine, California. Each party hereby waives any and all claims, pleas or defenses (including without limitation a plea for forum non conveniens) that would permit such party to seek the jurisdiction of any courts or arbitration tribunals other than those set forth in the preceding sentence.

EACH PARTY HEREBY WAIVES, TO THE FULLEST EXTENT PERMITTED BY APPLICABLE LAW, ANY RIGHT IT MAY HAVE TO A TRIAL BY JURY IN ANY LEGAL PROCEEDING DIRECTLY OR INDIRECTLY ARISING OUT OF OR RELATING TO THESE TERMS.

Notes



Making the building shell **airtight** and **windtight**

Dear professional user

Do you have any questions concerning SIGA products or SIGA services?
Find out more at www.sigacover.com or calling 1-855-SEE-SIGA

I bond safely
and quickly
with SIGA

