

**1-Button Remote**  
**2-Button Remote**  
**3-Button Remote**

**Model TC-318-1**  
**Model TC-318-2**  
**Model TC-318-3**

**1. INTRODUCTION**

Thank you for your purchase of a SkylinkHome™ Remote, Model TC-318-1 / TC-318-2 / TC-318-3. This remote which is also called transmitter in this document allows you to wirelessly operate SkylinkHome™ receiver modules.

All wireless signal communications within the SkylinkHome™ system are based on rolling code technology to ensure highest security is used.

The following items are included in this package:

- One of TC Series Remotes
- Lithium Battery CR-2032 (Installed)
- User's Instructions

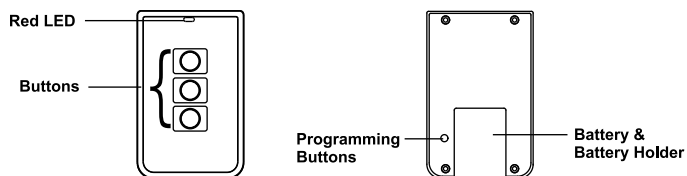

**2. POWER UP**

To power the transmitter, simply remove the battery isolator from the transmitter, red LED will flash once. Press the button on the transmitter, the red LED should flash. The transmitter is now powered properly. If the red LED does not flash when button is pressed, refer to Section 7 "Battery" of this manual.

- 1) Remove isolator,
- 2) LED on for 1 second

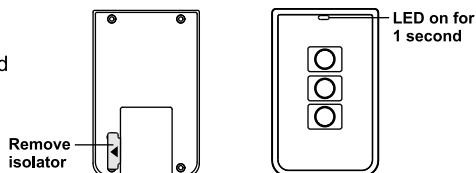

**3. PROGRAMMING TRANSMITTERS TO RECEIVER MODULE**

In order to operate the receiver module remotely with a transmitter, it must be programmed to the receiver module.

To program a remote to the receiver module, a "Learn" code must be transmitted, follow the instructions below to transmit the "Learn" code to the receiver.

1. Put the receiver module that you plan to program into programming mode. Refer to the User's Instructions of that receiver module.
2. Use a sharp object to press the "PROG" button on the back of the transmitter. The red LED on the transmitter will be on for 15 seconds.
3. Press the button on the remote that you plan to use when the LED is steadily on to transmit the "Learn" code.
4. Once the remote is programmed, the receiver modules will quit from programming mode and the programmed transmitter is ready to be used now.

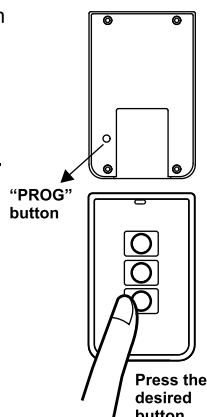

**3. PROGRAMMING TRANSMITTERS TO RECEIVER MODULE (CONT)**

**Learn Code**

Follow steps 2 and 3 above to transmit the "Learn" code when programming the remote to receiver modules.

You may follow the same instructions to program different buttons on the transmitter to different receiver modules.

**4. ON / OFF OPERATION**

Pressing the programmed button on the transmitter once will toggle the status of the load that is connected to the receiver module, i.e. if the light is off, pressing the button turns on the light, and vice versa.

When the programmed button is pressed, the red LED flashes briefly indicating signal is transmitting.

**5. BRIGHTNESS CONTROL OPERATION**

Besides turning on and off a light, you may also control the brightness of the light if the receiver module and the light bulb is dimmable, i.e. either incandescent light or dimmable compact fluorescent light.

To change the brightness, first turn on the light.

Then press and hold the programmed button on the transmitter will change its brightness. Hold the button until the desired brightness is reached, then release the button.

Press and hold the same button again on the transmitter to change the brightness again in the opposite way. When the desired brightness is reached, release the button.

**6. ERASING TC SERIES TRANSMITTERS**

There are 2 types of receivers and erasing transmitter from these 2 types of receivers are different. Please follow the erase procedure based on the receiver you have.

**Type A) Self Erase - Model PL-318, PR-318, PA-318, LS-318, WR-001**

Self Erase means there is a erase button on the receiver, by pressing this erase button, all transmitters can be erased.

To erase transmitters from these receivers, simply follow the instructions of these receivers. The erase procedure does not involve the transmitter.

**Type B) Erase by Remote - Model LX-318, MD-318, MR-318, WE-001**

Erase by Remote means there is no erase button on the receiver, so a programmed transmitter is needed in order to erase the memory of the receiver. You need to transmit a "Erase" code from the Remote. Follow the instructions below to erase the remote from the receiver.

1. Press the PROG button on the back of the remote.
2. Press and hold a button that is already programmed to the receiver for at least 2 seconds when the LED is steadily on to transmit the "Erase" code. Do not release this button until step 4.
3. Put the receiver that you want to erase the transmitter from into programming mode. Refer to the User's Instructions of that receiver.
4. Once the receiver receives this "Erase" code, the receiver will indicate it has erased all transmitters, and you may now release the button on the remote.

**Erase Code**

Follow steps 2 and 3 above to transmit the "Erase" code when erasing the remote from Type B receivers.

## 7. BATTERY

When the operating range is reduced, or when the red LED does not flash during operation, it is time to replace the battery.

The transmitter is powered by a lithium battery CR-2032. Follow the instructions below to replace the battery to the transmitter.

1. Slide out the battery door from the unit.

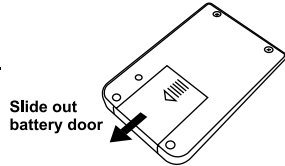

2. Remove the old battery.  
Insert a new CR-2032 lithium battery to the battery holder. Positive side facing up.

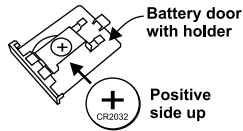

3. Insert the battery door to the transmitter.  
The red LED on the front of the unit will be on for 1 second.

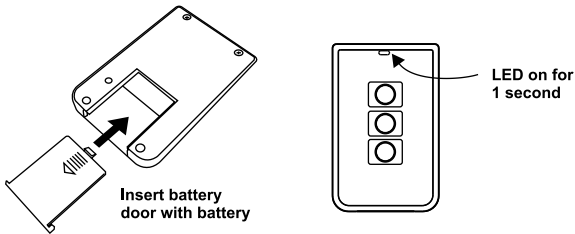

Note: Dispose of old batteries promptly and properly.

## 8. RESET REMOTE CONTROL

You can reset the remote control by following the instructions below. After you reset the remote control, the unique remote ID will be changed. Therefore, it is required to program the remote again to all the receivers that you have programmed before.

1. Slide out the battery door;
2. Hold the "PROG" button on the back and slide back the battery door.
3. When the front LED flashes quickly, release the button.
4. The red LED will then flash 3 times slowly. This indicates the remote has been reset. You should now program the transmitter to all the receivers that you want to control.

If you lost a remote, to ensure security and safety, you should erase all remotes from all receivers and reprogram all existing remotes. Please refer to the erasing method of each receiver.

## 9. FCC

The device is approved by the FCC and it complies with Part 15 of the FCC Rules. Its operation is subject to the following two conditions :

1. This device may not cause harmful interference.
2. This device must accept any interference that may cause undesired operation.

### WARNING:

Changes or modifications to this unit not expressly approved by the party responsible of compliance could void the user's authority to operate the equipment.

## 10. WARRANTY

If, within one year from date of purchase, this product should become defective (except battery), due to faulty workmanship or materials, it will be repaired or replaced, without charge. Proof of purchase and a Return Authorization are required.

## 11. CUSTOMER SERVICE

If you would like to

- find out the up-to-date specifications
- know more about features and applications
- download documents, i.e. user's instructions
- order Skylink products

or if you have difficulty getting products to work, please:

1. visit our FAQ section at [www.skylinkhome.com](http://www.skylinkhome.com), or
2. email us at [support@skylinkhome.com](mailto:support@skylinkhome.com), or
3. call our toll free at 1-800-304-1187 from Monday to Friday, 9 am to 5 pm EST. Fax (800) 286-1320

## 12. ACCESSORIES

The SkylinkHome™ System consists of many other devices such as SkylinkHome™ Remotes, Motion Sensor, ON/OFF Wall Switch, Wall Dimmer, Plug-In Dimmer with or without Repeater, Plug-In ON/OFF Control (Outdoor/Indoor), Screw-In Dimmer, ON/OFF/Dimming Control, ON/OFF Control, Smart Button™ Garage Door Control, etc. Please visit Skylink website at [www.skylinkhome.com](http://www.skylinkhome.com) for more information.



### CUSTOMER SERVICE

17 Sheard Avenue, Brampton, Ontario, Canada L6Y 1J3  
Email: [support@skylinkhome.com](mailto:support@skylinkhome.com)  
<http://www.skylinkhome.com>  
P/N. 101Z696  
Patent Pending  
©2010 SKYLINK GROUP